



The Big Lobster at Kingston in the South East of South Australia is affectionately known as “Larry”. The Big Lobster structure has an internal steel frame, which is coated with layers of styro-foam and fibreglass. It took approximately six months to build.

Height: 17 Metres

Weight: 4 Tonnes (approximately)

Length: 15.2 Metres

Width: 13.7 Metres

KINGSTON VISITOR INFORMATION OUTLET

29 Holland Street, Kingston SE
www.kingstondc.sa.gov.au/discover

Opening Hours

Monday - Friday
8:30am - 5:00pm

Saturday - Sunday

Kingston Foreshore Caravan Park
34A Marine Parade
8:00am - 7:00pm

Local Tourism Information
Regional Tourist Information
State Tourist Information
Maps & Directories
Community Displays
Free Internet Access
Current Events & Activities



29 Holland Street (PO Box 321)
Kingston SE SA 5275
Ph: 08 8767 2036
Email: vio@kingstondc.sa.gov.au

THE BIG LOBSTER



KINGSTON SE

HISTORY

The Big Lobster was built in 1979 and officially opened by the Hon David Tonkin, Premier of South Australia on 15 December 1979.

The original idea came from a similar concept the Backler family discovered in the USA in the mid 1970s. Their plan for the project in Kingston featured the promotion of South Eastern seafood, wine and cheese.

Highway figures of vehicle numbers travelling the Princes Highway encouraged the development, provided that tourists stopped in Kingston. The construction of a giant lobster in front of the complex was to be the drawcard to achieve this.

The Backler and Moyse families jointly spearheaded the project. Architect Ian Hannaford undertook the design, Harold and Kite were the builders and Paul Kelly of Adelaide took on the building of the actual Big Lobster.

A decision was made to sell exclusively South East Wines and strongly promote Coonawarra and Padthaway vineyards. The Mount Benson Wine Region was not included, as it had not yet developed at the time. The SA Government was approached and the Big Lobster was successful in developing the first Tourist Licence for South Australia.

Howard Dicker played a significant part in carrying out the earthworks and also transported all of the sections of the Lobster from Adelaide to Kingston. Traffic came to a standstill along the highway when drivers saw the huge structure moving along the road.

Chefs from the SA School of Food and Catering were brought down to the centre to train local staff in food preparation and presentation. Lobsters were brought in daily and cooked on site (in season).

A great emphasis was placed on promotion, particularly along the east coast of Australia. This proved very successful and on many occasions up to 7 coaches at a time were stopped at the Big Lobster for lunch, in addition to individual tourists.

TODAY..

The Big Lobster is still a major attraction, and has become an icon for Kingston.

The complex is located at, 6 Princes Highway, KINGSTON SE SA 5275.

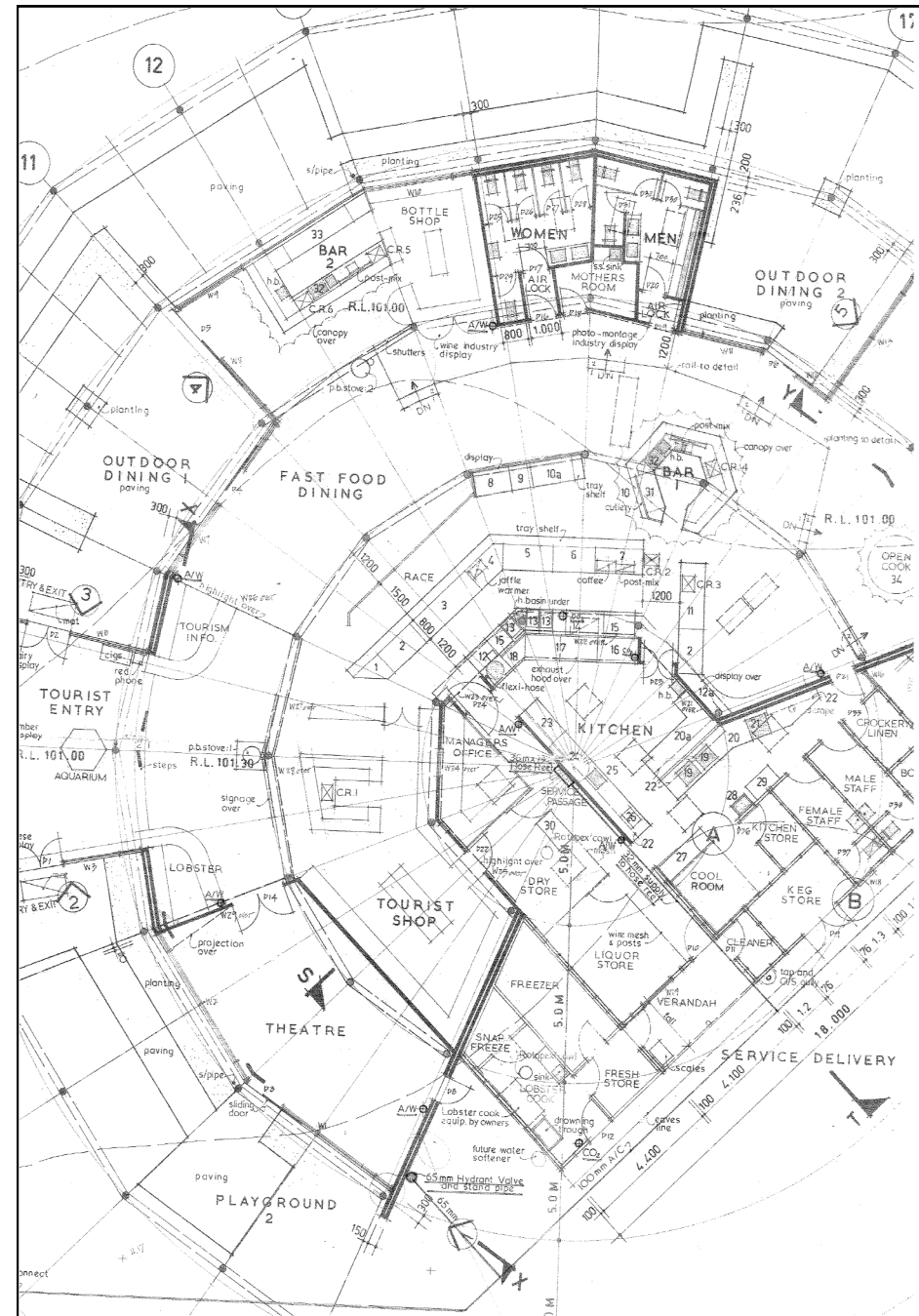

Original design of the Big Lobster Tourist Centre